

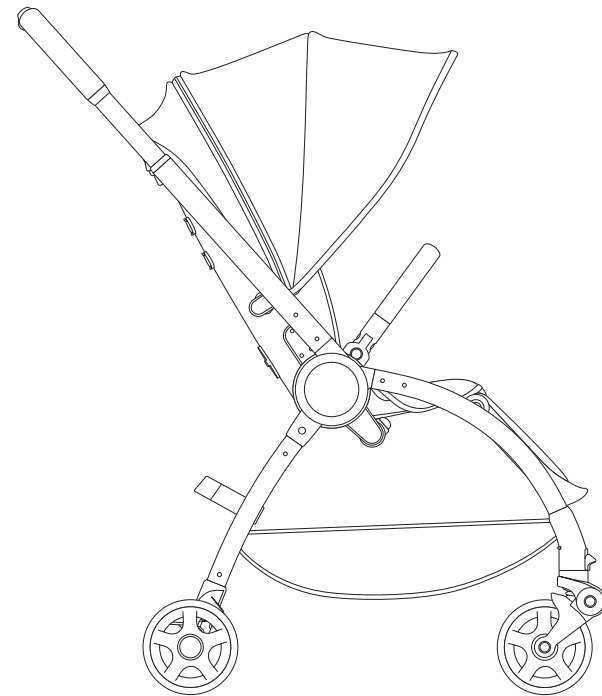

# Kuro Stroller



## IMPORTANT

Read these instructions carefully before use and keep them for future reference. Your child's safety may be affected if you do not follow these instructions. This vehicle is intended for children from birth up to a maximum weight of 15kgs.

Complies with BS EN 1888 : 2012  
Customer Care Line: 01454 326 568



# CARE AND MAINTENANCE

## General care:

- The correct use and maintenance of this stroller is essential.
- Do not use excessive force when folding the stroller.
- If you are having problems, fully open the stroller and repeat the folding procedure.
- Always let wheels down as gently as possible when mounting and dismounting kerbs.
- Always fold the stroller when going up or down stairs.
- Never bump the stroller over these or similar obstacles.
- In some climates mould and mildew can affect the fabric and rain cover. To avoid this, do not fold the stroller when it is wet. Leave it open in a ventilated area until completely dry.
- Always store the stroller in a dry place.
- When storing the stroller in the car, never place other items on top of it.
- Do not exceed the maximum load of 2 kgs in the shopping basket.  
(Where provided).

## Cleaning:

- Fabric covers and trims may be spot washed using mild detergent and warm water. Leave to dry in a ventilated area away from direct sunlight.
- Avoid leaving your buggy in direct sunlight for prolonged periods of time as this may cause fabrics to fade.
- Do not dry clean, machine wash or tumble dry.
- Metal parts may be cleaned with a damp cloth.
- Always wipe dry. Clean plastic parts with a mild soap and water solution, wipe dry.

## Maintenance:

- Maintain your stroller by lubricating all metal moving parts with a silicone based lubricant. Do not use heavy machine oil or grease as this can attract dirt or grit.
- Check that nothing is loose or broken and that no sharp edges have been exposed. Inspect all joints and the harness, replace any damaged parts immediately.
- Inspect any nuts and bolts regularly to ensure none have worked loose. Tighten as necessary.
- Only use replacement parts and accessories that have been approved by the manufacturer. Failure to do this may invalidate your warranty.

## Usage Instructions

### Maxi Cosi Adaptors Setup And Removal

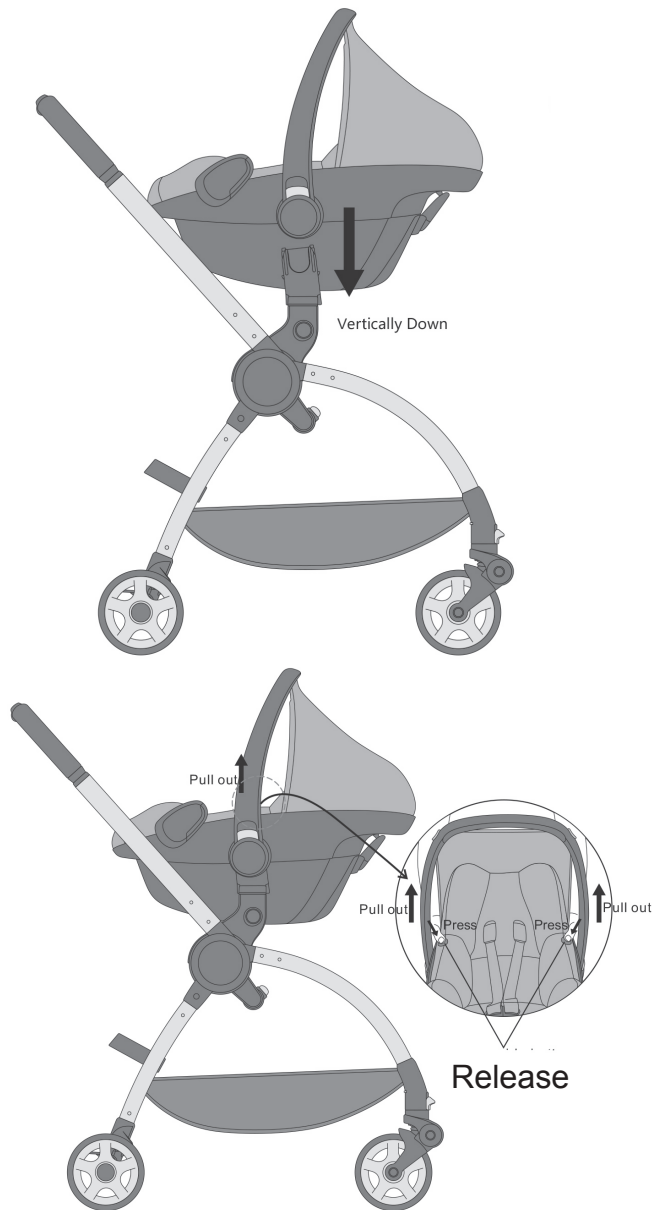

## WARNINGS

### Safety warnings:

- WARNING: Never leave your child unattended.
- WARNING: To avoid injury ensure your child is kept away when unfolding and folding this product.
- WARNING: Do not let your child play with this product.
- WARNING: Always use the restraint system.
- WARNING: This product is not suitable for running or skating.
- WARNING: Your child's safety is your responsibility.
- WARNING: Any load attached to the handle affects the stability of the pram / pushchair.
- WARNING: Ensure that all the locking devices are engaged before use.
- Not intended for children weighing more than 15kgs. This stroller is designed for one child only.
  - The brake must always be engaged when placing and removing children from the stroller.
  - Any load attached to the handle and/or on the backrest and/or on the sides of the vehicle will affect the stability of the stroller.
  - Lift a child in and out of the stroller. Do not allow a child to stand on the footrest or seat.
  - Do not use accessories that have not been approved by the manufacturer.
  - Never use the buggy to carry a child up and down stairs or escalators. Remove your child and fold the pushchair when going up or down stairs / escalators.
  - For newborns, it is advisable to use the seat units in the fully reclined position.

This product complies with BS EN 1888 : 2012  
For all technical queries please call: 01454 326 568

Imported by:

The Red Kite Baby Co Ltd. 35 Lavenham Road, Beeches Industrial Estate  
Yate, Bristol, BS37 5QX

# PARTS

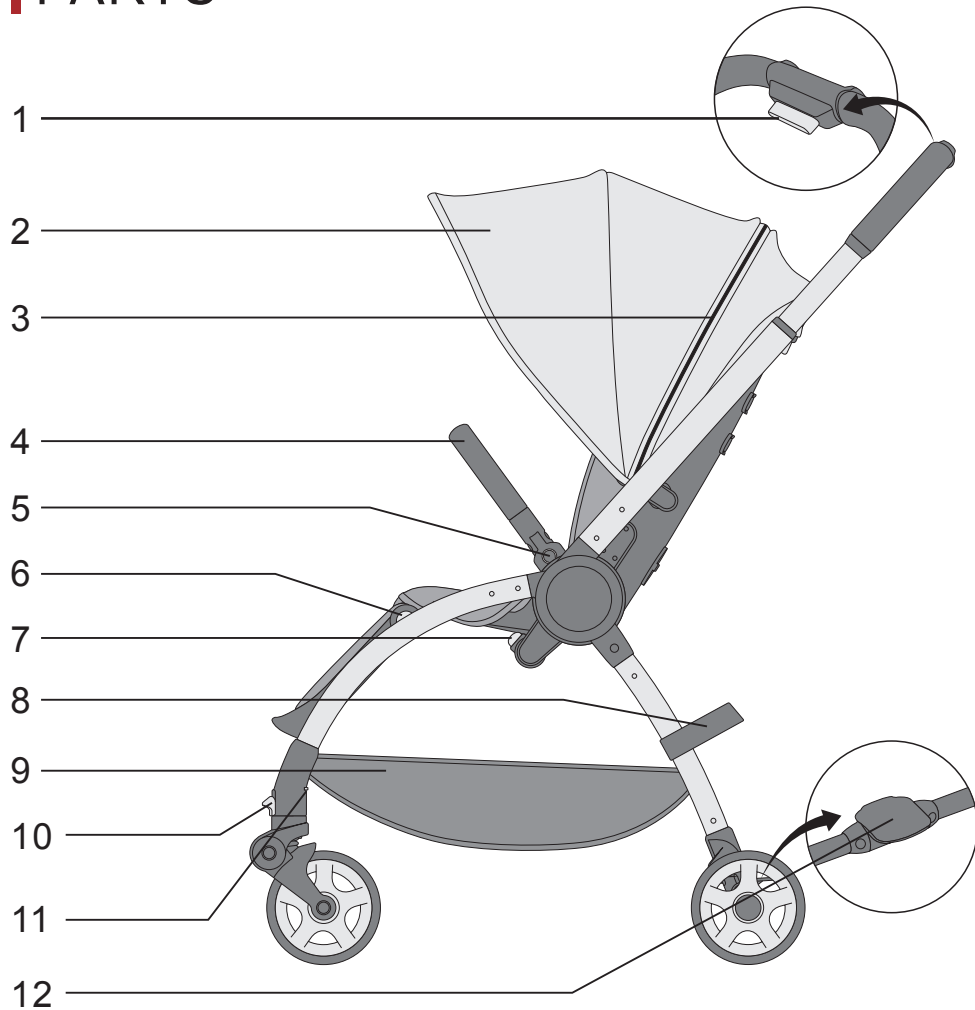

- |                               |                               |
|-------------------------------|-------------------------------|
| 1. Handle Extension Button    | 7. Folding Lock Button        |
| 2. Hood                       | 8. Folding Hook               |
| 3. Hood Zip                   | 9. Shopping Basket            |
| 4. Detachable Bumper Bar      | 10. Front Wheel Swivel Lock   |
| 5. Bumper Bar Detach Button   | 11. Front Wheel Detach Button |
| 6. Footrest Adjustment Button | 12. Brake Pedal               |

# Usage Instructions

## Maxi Cosi Adaptors Setup And Removal

### Car seat model compatibility:

Cabriofix  
Citi  
Pebble  
Pebble Plus

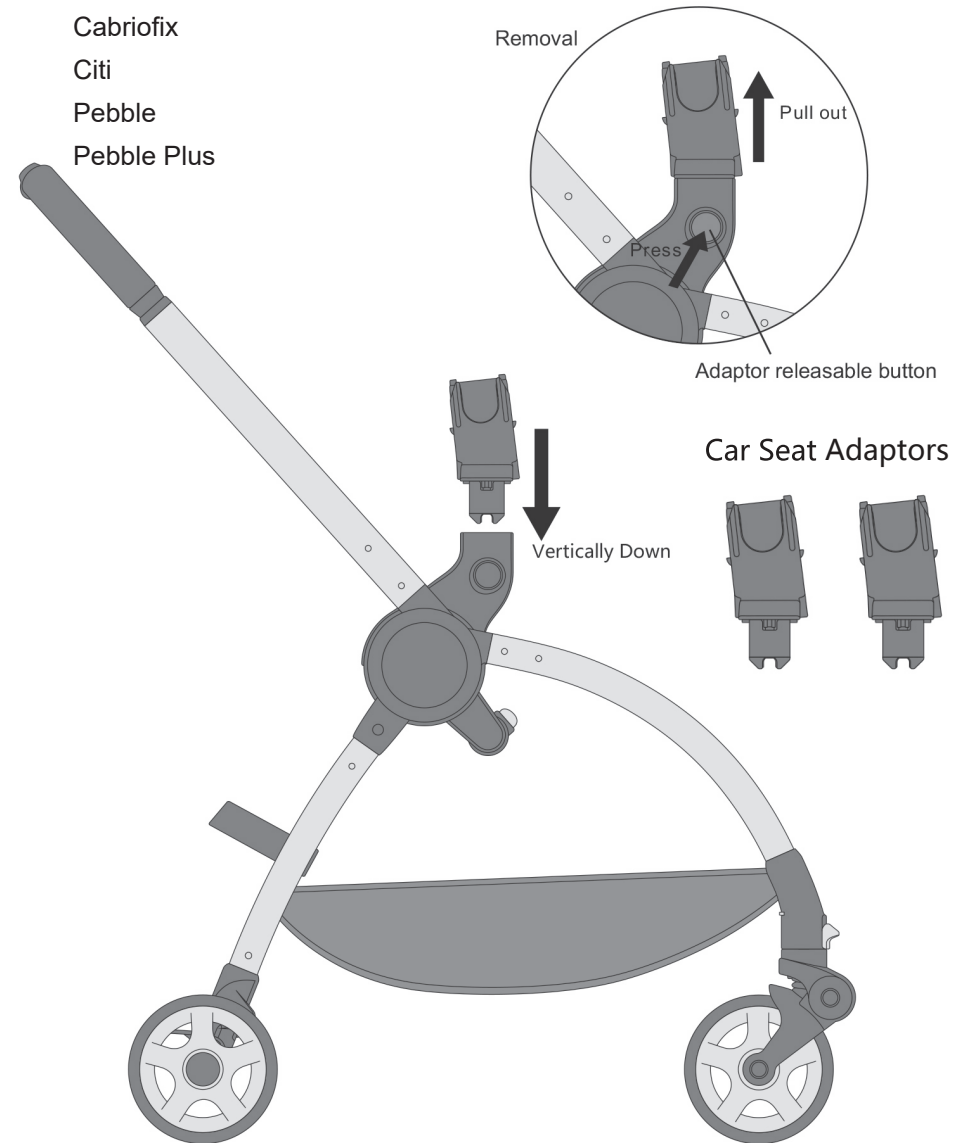

# Usage Instructions

## Car Seat Adaptor Setup And Removal

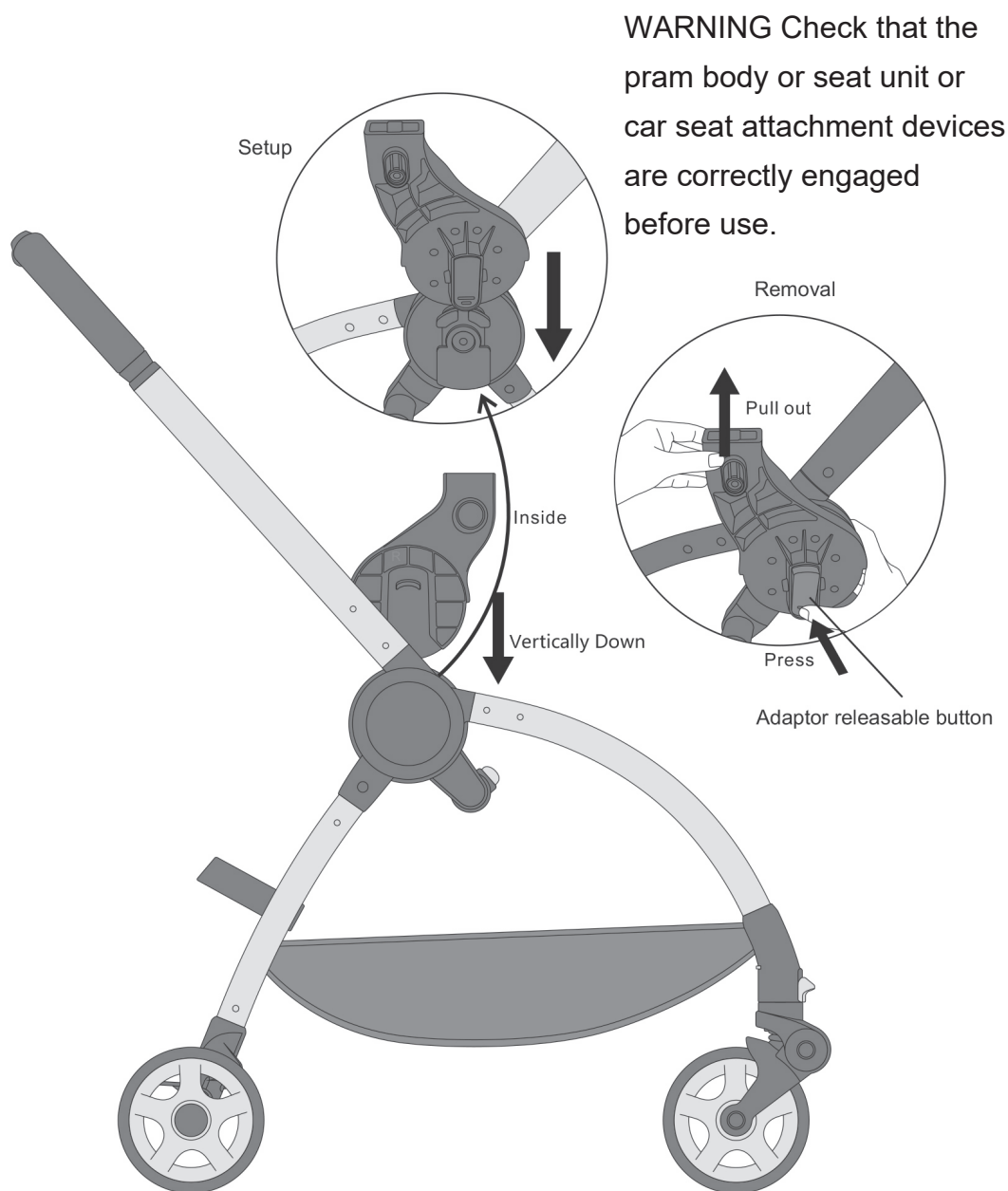

# PARTS

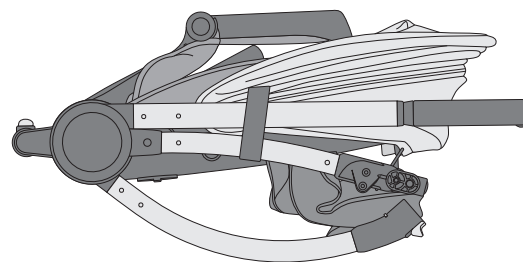

- Chassis x 1  
including seat and bumper bar

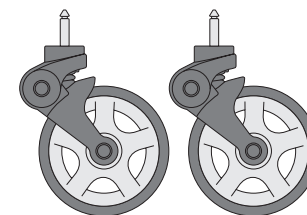

- Front Wheel x 2

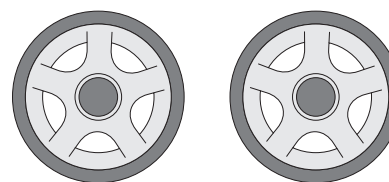

- Rear Wheel x 2

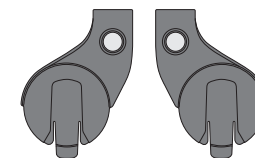

- Seat adaptors x 2

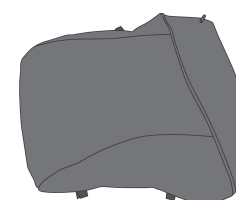
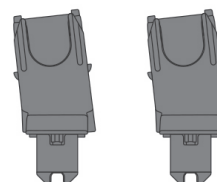

- Maxi Cosi adaptors x 2
- Foot cover x 1
- Raincover x 1

## NOTE

A raincover is supplied with this stroller. The raincover should be placed over the hood to use and secured with the velcro and elastic tabs. It should be folded and placed in the basket when not in use.

# Assembly Instructions

## Chassis Opening

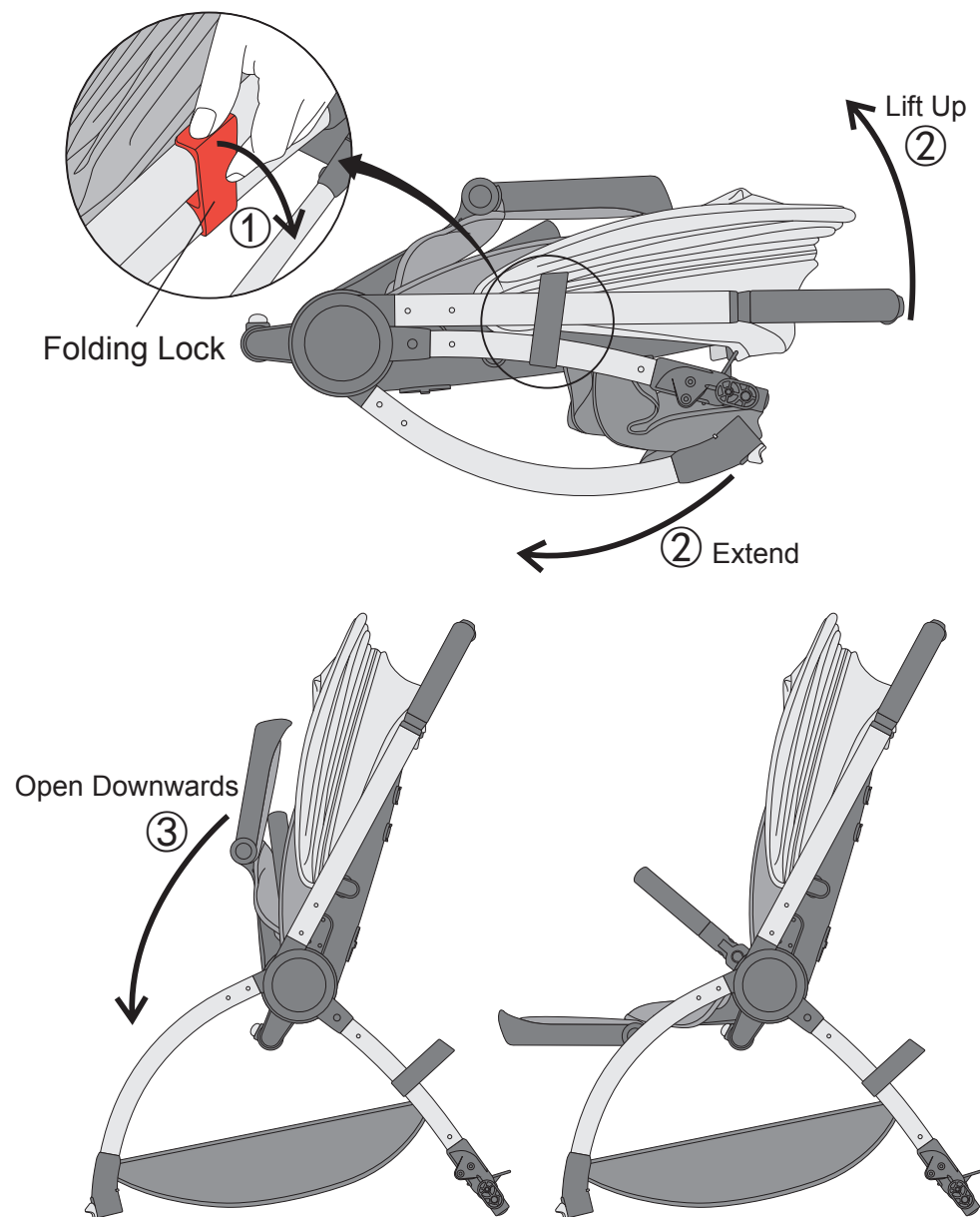

# Usage Instructions

## Folding the stroller with reversed seat

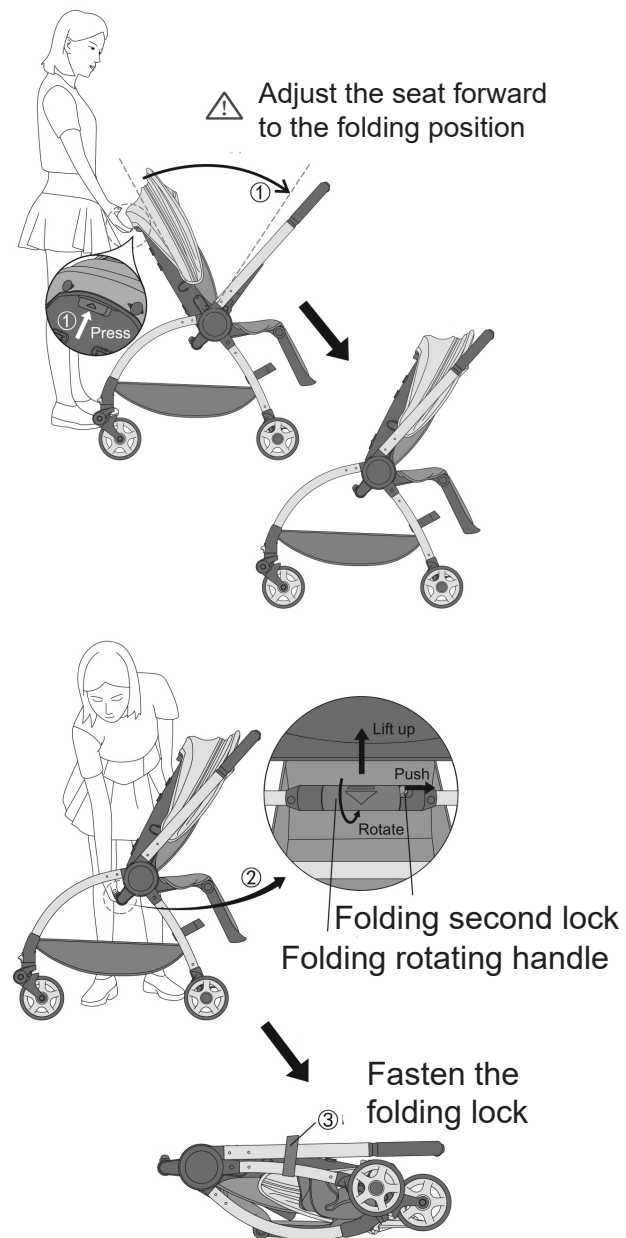

# Usage Instructions

## Folding the Stroller with Forward Facing Seat

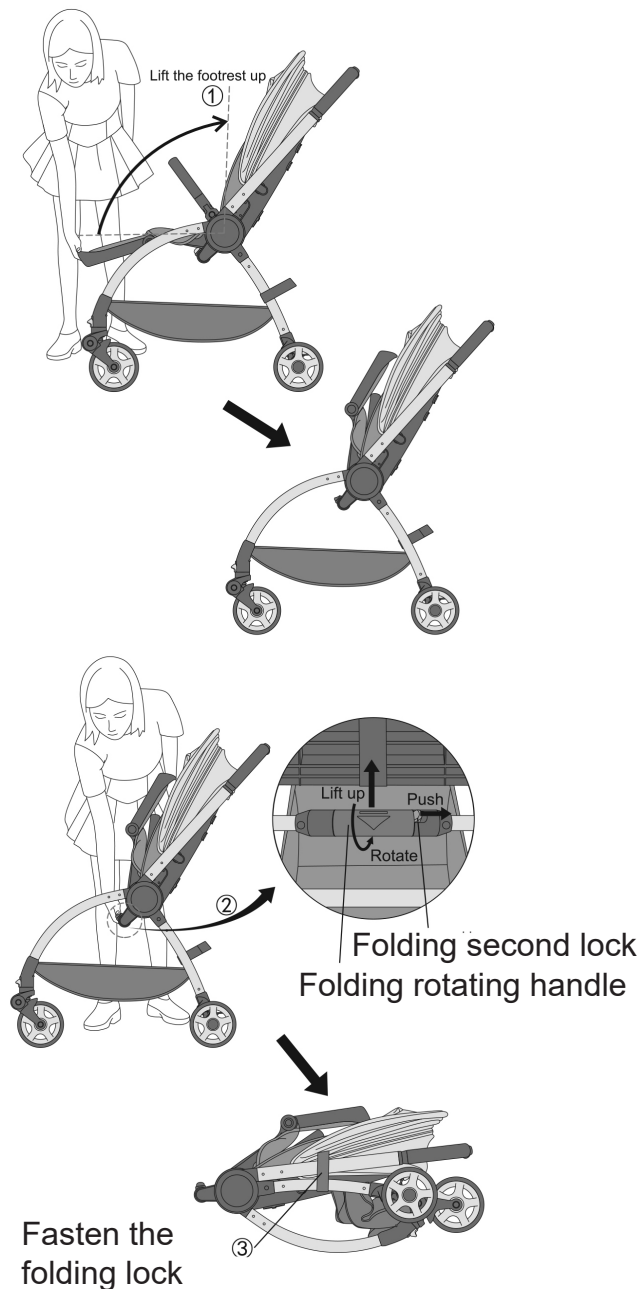

# Assembly Instructions

## Front & Rear Wheel Installation

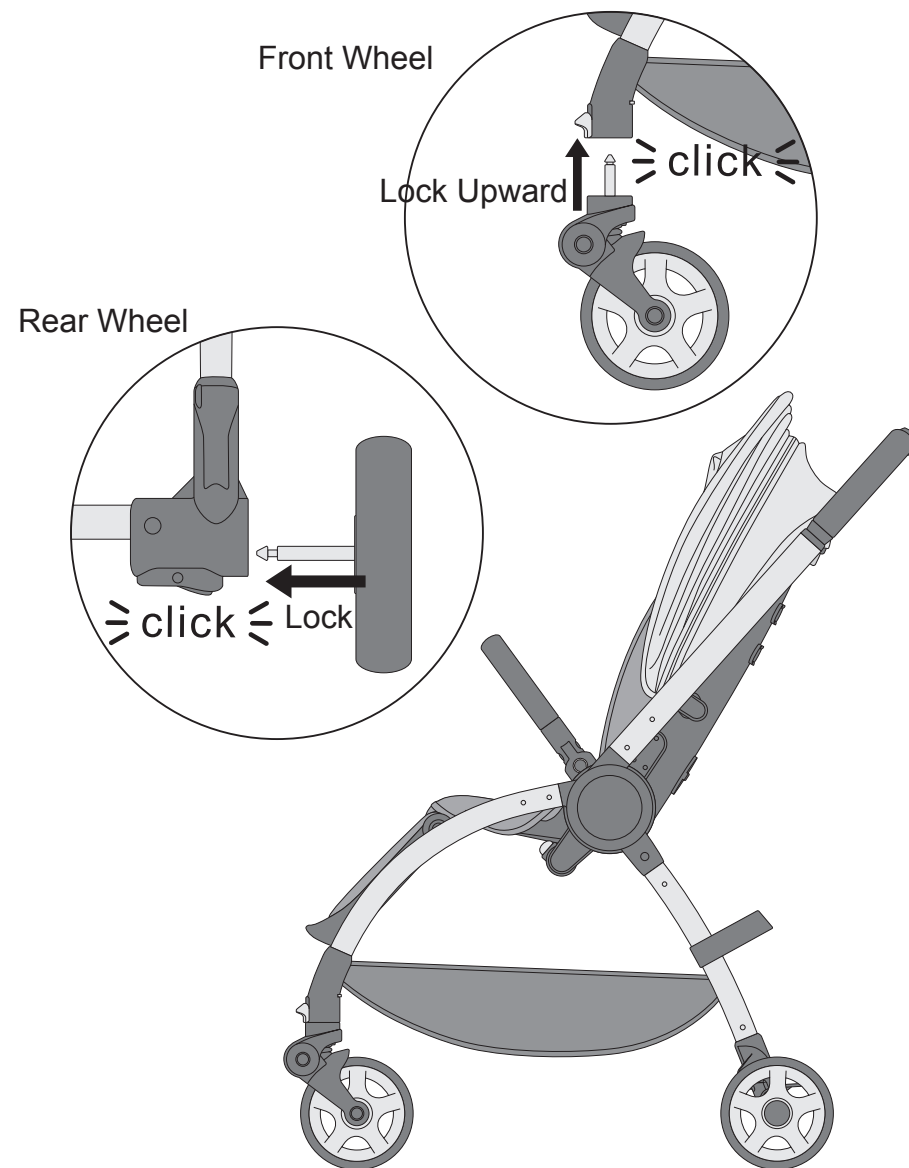

# Usage Instructions

## Front & Rear Wheel Assembly and Removal

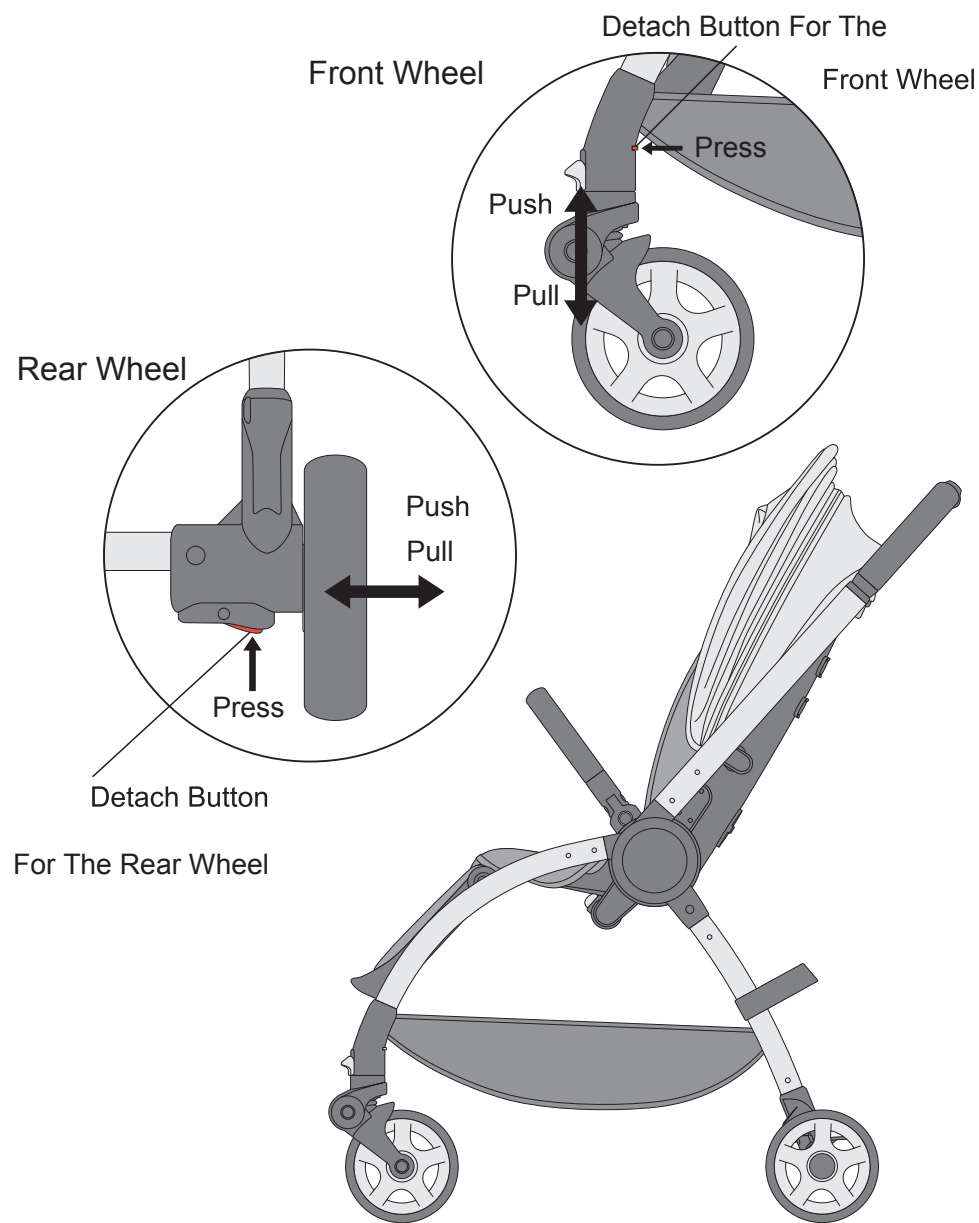

# Usage Instructions

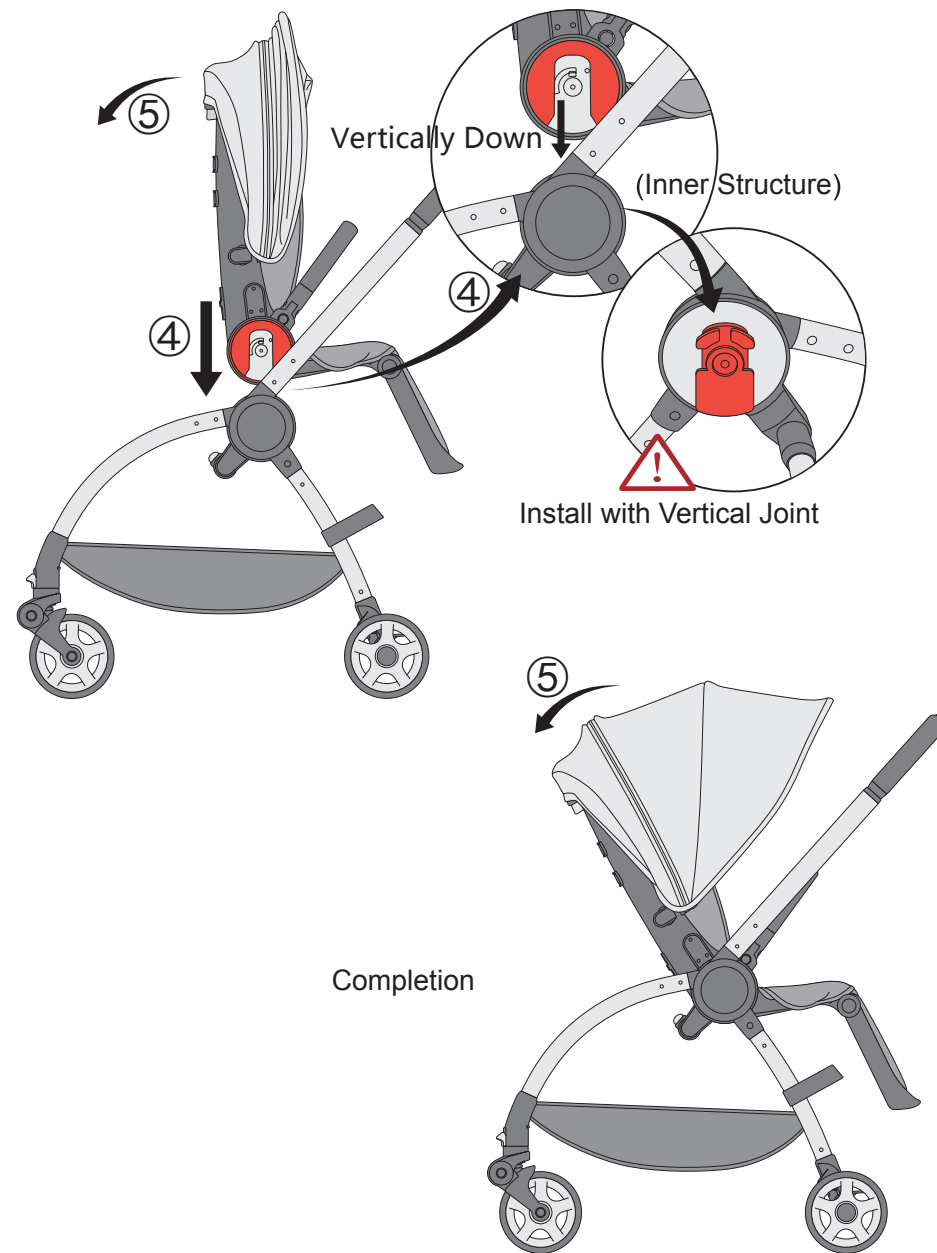

## Usage Instructions

### To Reverse The Seat

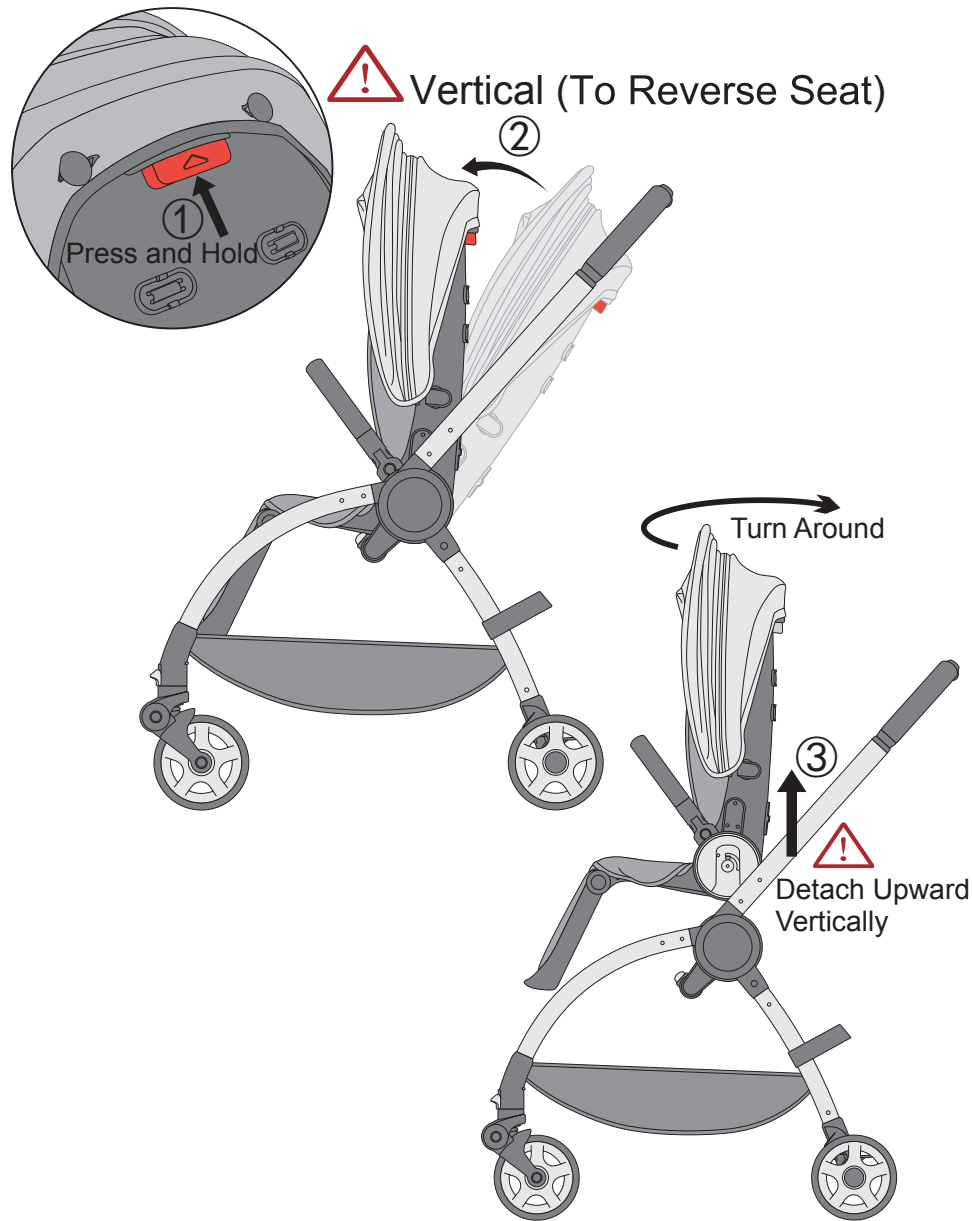

## Usage Instructions

### Steering And Braking

Front Wheel

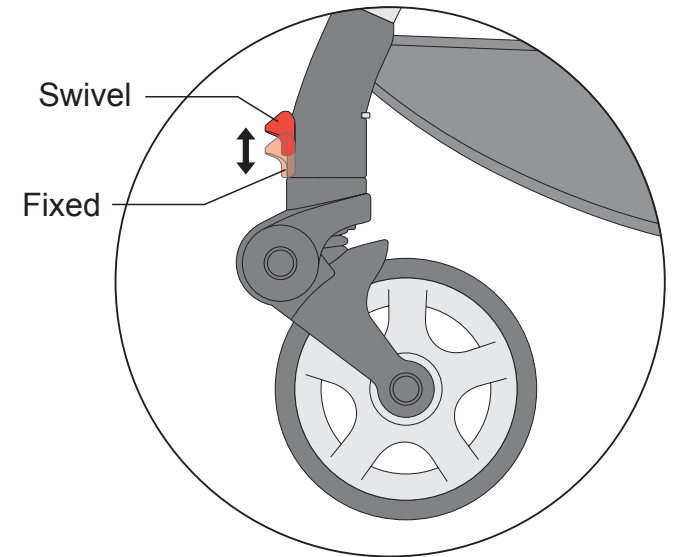

Rear Wheel

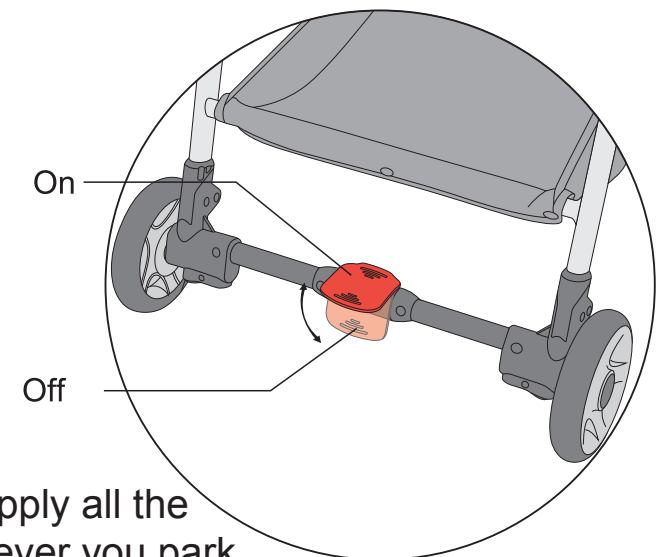

**WARNING** Apply all the brakes whenever you park the stroller.

# Usage Instructions

## Bumper Bar Setup And Removal

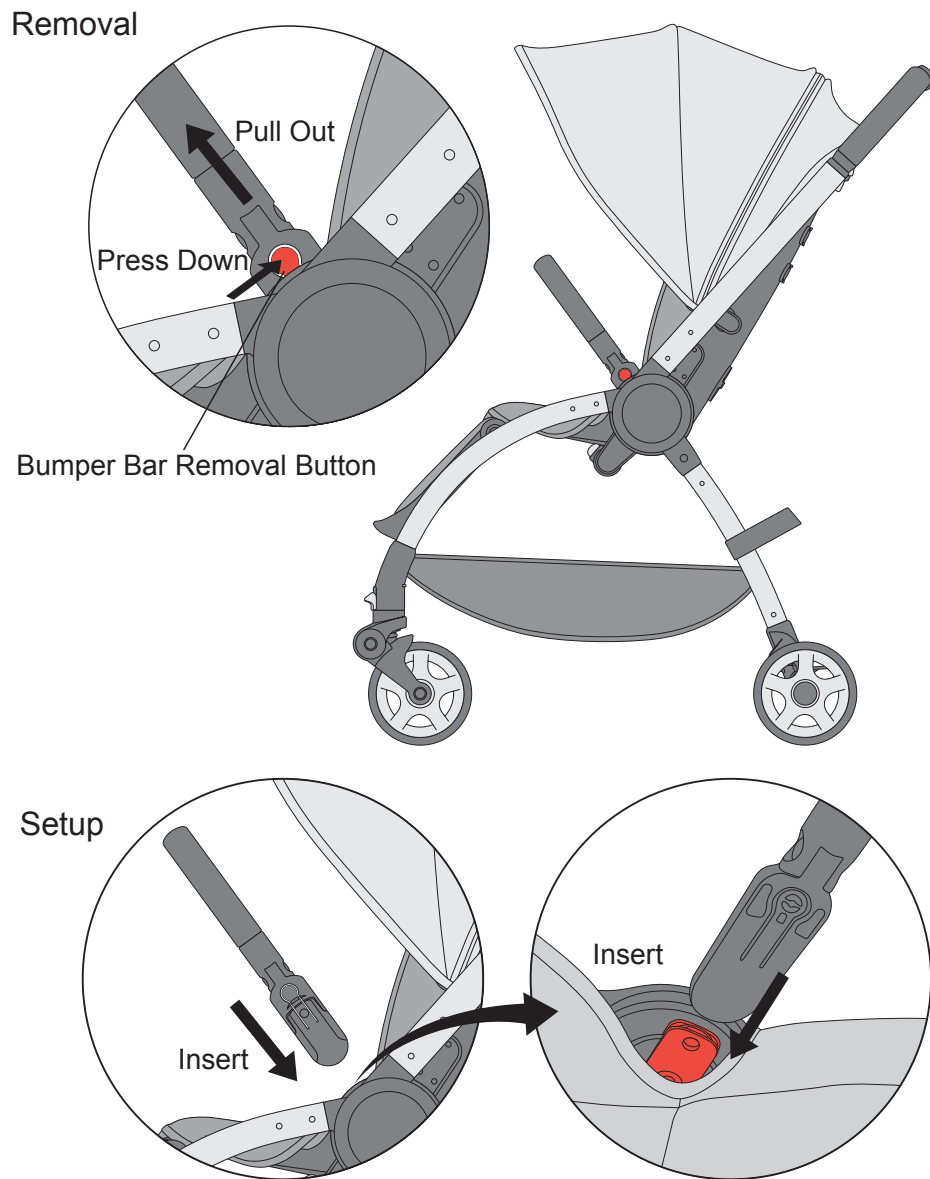

# Usage Instructions

## Backrest Adjustment

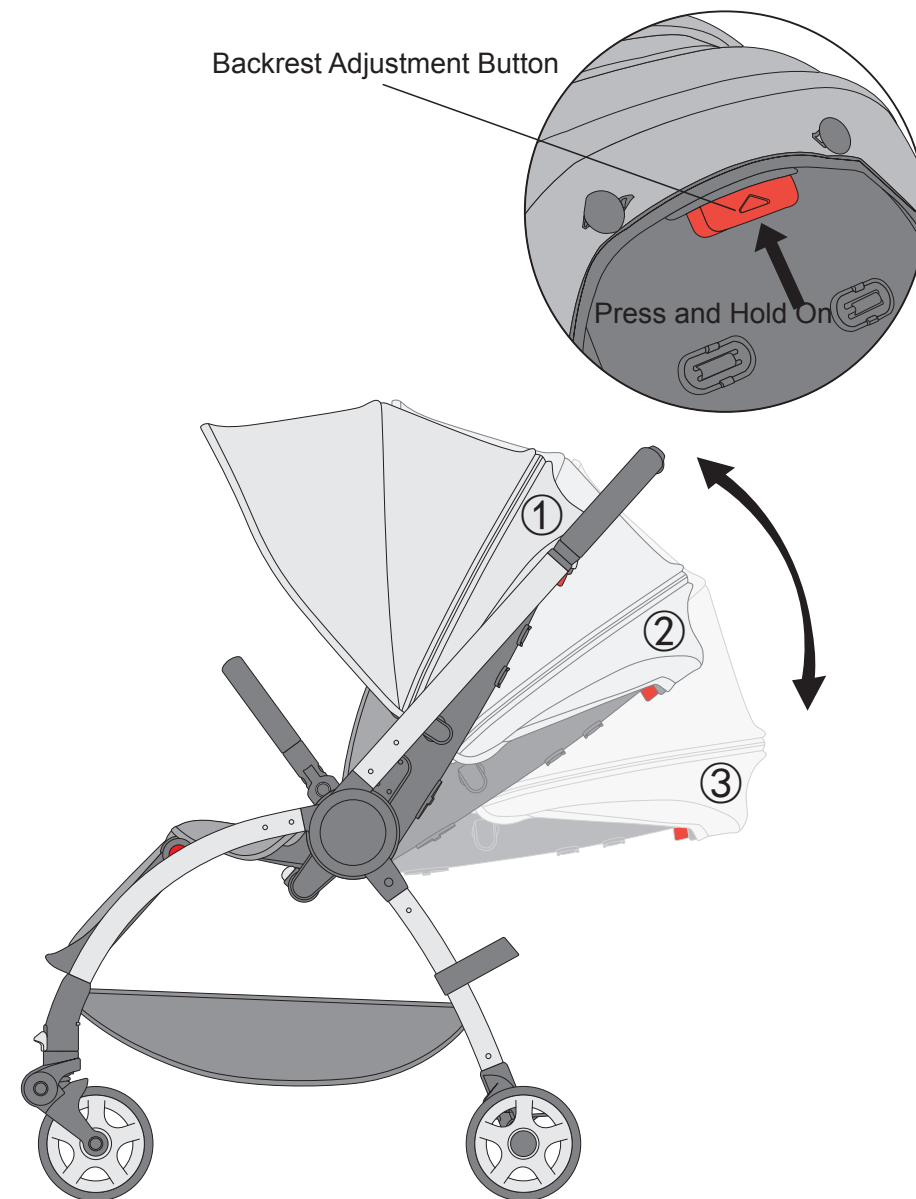

# Usage Instructions

## Handle Extension

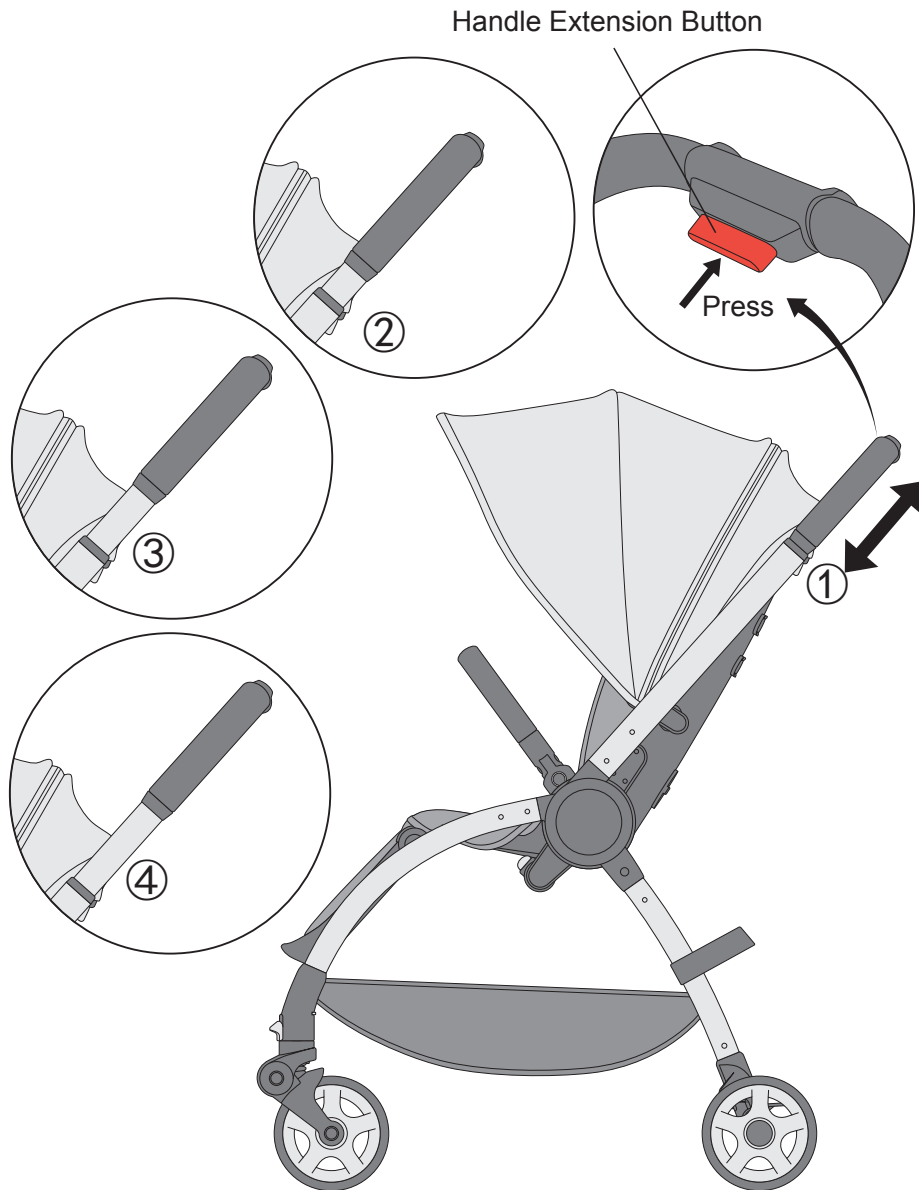

# Usage Instructions

## Hood Setup And Removal

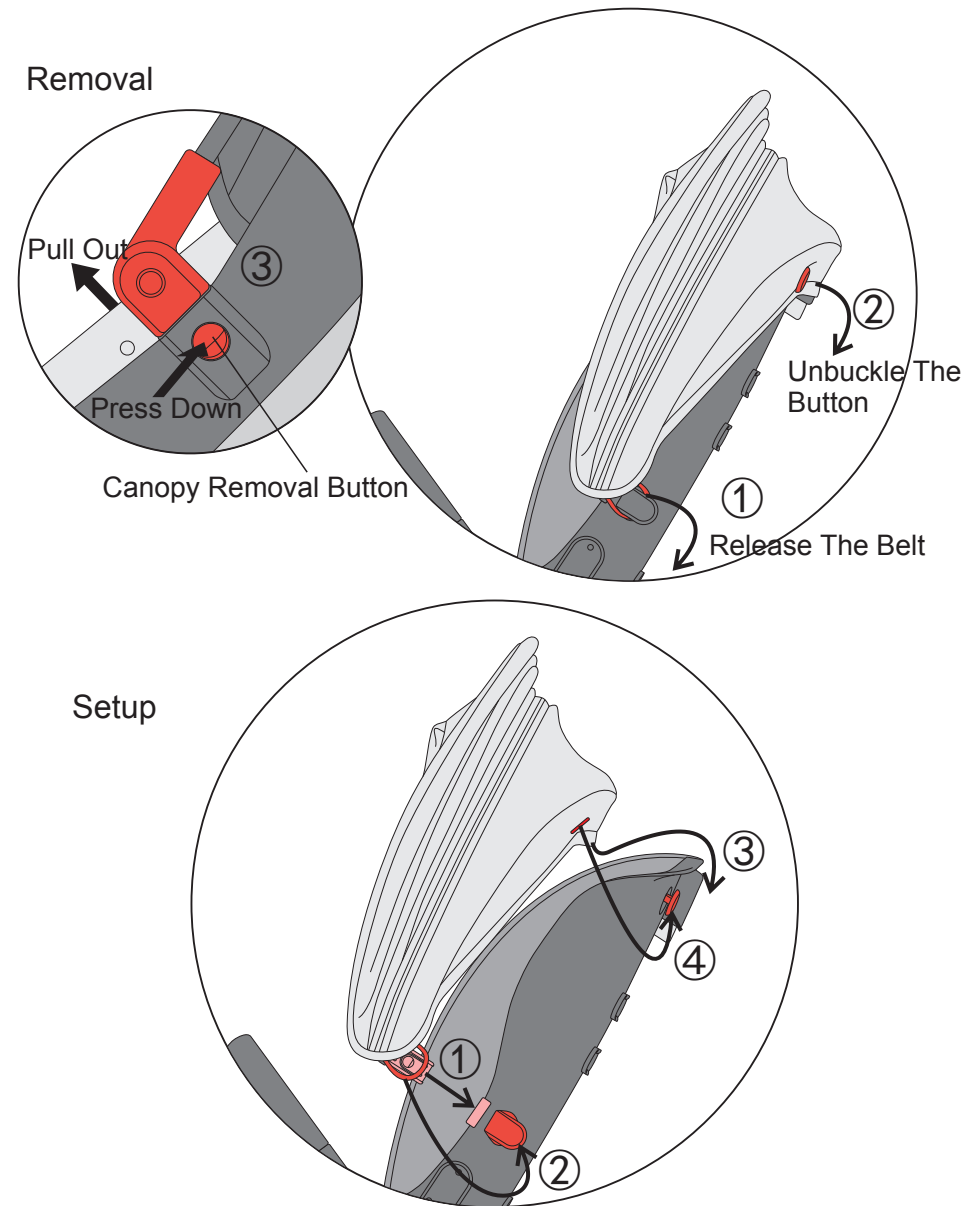

## Usage Instructions **Harness Usage**

**WARNING!** Always use the crotch strap in combination with the waist belt.

**WARNING!** For babies aged 0 - 6 months the harness must be fed through the lowest retaining loops to prevent risk of strangulation.

### Buckle

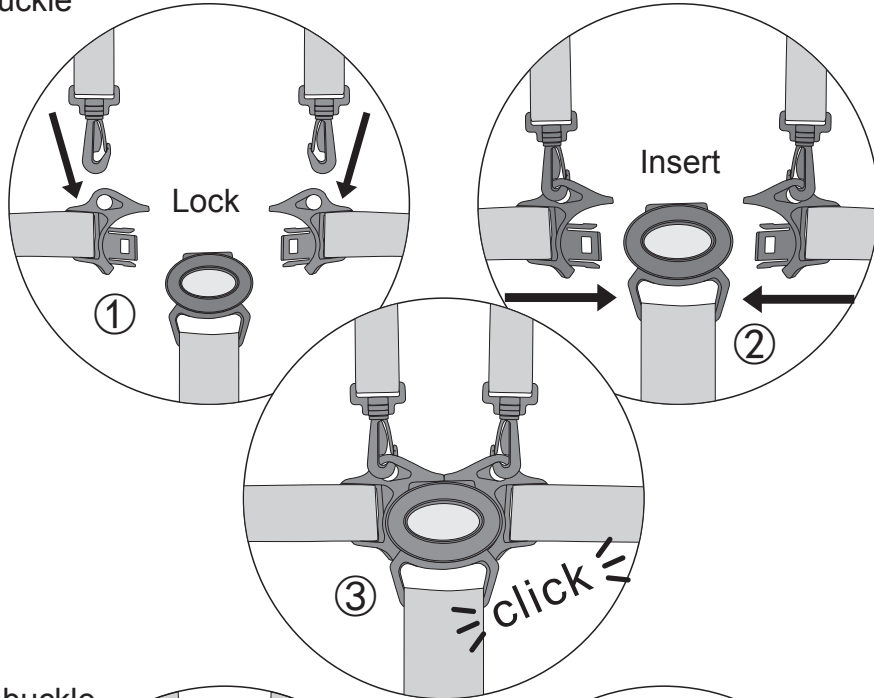

### Unbuckle

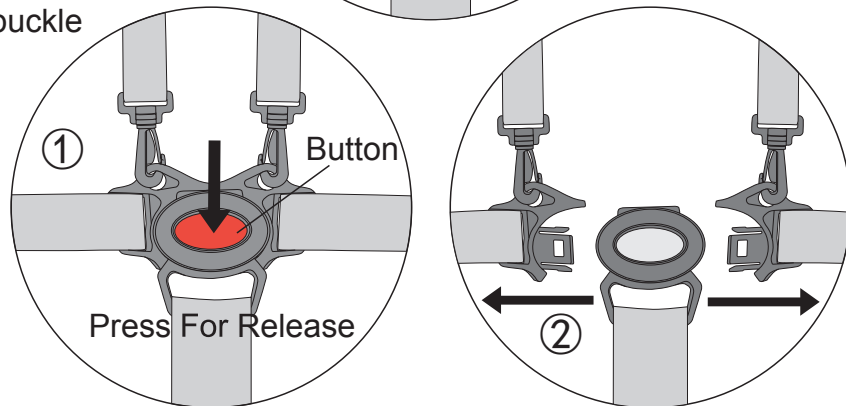

## Usage Instructions

### **Footrest Adjustment**

