



## **IMPORTANT**

Read these instructions carefully before use and keep them for future reference.

Your child's safety may be affected if you do not follow these instructions.

### **Instruction Leaflet**

## **Savanna Car Seat**

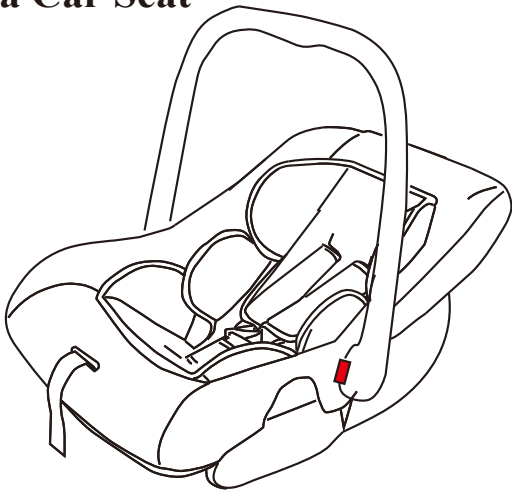

For infants up to 13kg (Group 0+).  
Conforms to ECE R44.04 Universal.  
Customer Care Line: 01454 326 568

# Important Safety Information

Read these instructions before fitting the car seat in your car or stroller so that you are familiar with it and avoid any potentially dangerous misuse.

- The Savanna group 0+ car safety seat has been subjected to all safety tests and is approved under European standard ECE R44/04, for children of weight from 0 to 13 kg (0 to 12-15 months).
- **IMPORTANT:** The Savanna group 0+ car seat, must be installed facing opposite to the normal forward movement of the car, on seats without airbags. Do not install the Savanna group 0+ car seat on backward facing seats or seats arranged facing each other.
- **WARNING:** Read the instructions carefully before use and retain for future reference. Failure to closely follow the installation instructions for the car safety seat will put your child at risk.
- The assembly and installation operations must be conducted by adults.
- Avoid inserting fingers into the mechanisms.
- Install this group 0+ car safety seat facing opposite to the normal forward movement of the vehicle.
- Death or serious injury can result if this car safety seat is installed on seats with airbags.
- Eliminate danger by disabling airbags surrounding the position of the car safety seat.
- In the case of rotating or movable seats it is important to install this safety seat facing opposite to the normal forward movement of the vehicle.
- When traveling take special care to make sure that luggage or other objects do not injure the child in the safety seat in the case of accidents.
- Do not use installation methods different from those indicated. This would result in the risk of detachment from the seat.
- Car safety seat, group 0+, “Universal” approved under European standard ECE R44/04 for children of weight from 0 to 13 kg (0 to 12/15 months). Suitable for installation on the majority of vehicle seats, but not all.
- The car safety seat can be correctly installed if the vehicle’s use and maintenance manual indicates compatibility with “Universal” group 0+ restraint systems.
- This safety seat is classed as “Universal” in compliance with stricter approval criteria than previous models that do not have approval labels.
- The safety seat can only be used in approved vehicles, fitted with static or inertia-reel three-point seat belts, approved under regulation UN/ECE no. 16 or equivalent standards. It must not be used with two-point or lap seat belts.
- Ensure that the three-point car seat belt fixing the safety seat is always taut and not twisted. It should be replaced in the case of heavy stress as a result of an accident.
- Never leave the child unattended in the safety seat: observe him/her even when sleeping.
- Never remove the child from the seat while the vehicle is in motion.
- Make sure that the safety seat is protected from any mobile parts of the car seat or doors.
- To avoid the risk of falling always use the safety seat harness even for transport outside the vehicle. Adjust the height and tension of the straps ensuring that they are snug to the child’s body without constricting him/her too much. Check that the harness is not twisted and that the child does not release it.
- **NEVER** lift the car seat by the hood.

- This car safety seat is not designed for extended periods of sleep. The safety seat is not a substitute for a cot and if the child needs to sleep it is important to lie him/her down.
- Do not leave the car safety seat in the car exposed to the sun. Some parts might heat up and be harmful to the delicate skin of the child -check before placing the child in the seat.
- Do not use the safety seat without its fabric covering, which cannot be replaced with one not approved by the manufacturer since it is an integral part of the safety seat and the safety system.
- If in doubt refer to the manufacturer or retailer of the safety seat.
- Do not remove the adhesive and stitched labels since this might make the product non compliant with legal requirements.
- Do not use the safety seat if it has signs of breakage or missing parts, is second hand, or if it has been subjected to violent stress in an accident, because it might have suffered extremely dangerous structural damage.
- Do not modify the product.
- Do not use this car safety seat after five years from the date of production indicated on the structure. The natural aging of the materials may mean that it may no longer be compliant with standards.
- The use of the safety seat for premature infants born at less than 37 weeks could cause respiration problems for the infant seated in the safety seat. It is advisable to seek medical advice before leaving the hospital.
- Do not use accessories not approved by the manufacturer or by the competent authorities.
- To avoid the risk of falling, never place the safety seat on raised surfaces (tables, work surfaces) soft surfaces (beds, sofas) or sloping surfaces.
- In the home do not use the car safety seat if the child is able to remain seated alone.

#### NOTICE

1. This is a "Universal" child restraint; it is approved to ECE Regulation 44.04 for general use in vehicles and will fit most, but not all, vehicle seats.
2. A correct fit is likely if the vehicle manufacturer has declared in the vehicle handbook that the vehicle is capable of accepting a "Universal" child restraint for this group.
3. This child restraint has been declared "Universal" under more stringent conditions than those applied to earlier designs which do not carry this notice.
4. If in doubt, consult either the child restraint manufacturer or the retailer.

Only suitable if the vehicle is fitted with 3-point static, 3-point retractor safety belts, approved to UN/ECE Regulation No. 16 or other equivalent standards.

**EXTREME HAZARD**  
Do not use in passenger seats equipped with airbags (SRS).

The instructions for use should be kept for future reference.

The correct use and maintenance of your car seat will ensure it gives long and trouble free use.

When somebody else is using your car seat, ensure they also know how to use it, especially the correct way to adjust it. The safety of your child is your responsibility.

1. PLEASE READ THOROUGHLY BEFORE COMMENCING INSTALLATION AS AN INCORRECT INSTALLATION COULD BE DANGEROUS.
2. PARENTS SHOULD NOT UNDER ANY CIRCUMSTANCES USE THIS CHILD RESTRAINT ON A PASSENGER SEAT EQUIPPED WITH AN AIRBAG.
3. The child seat must only be installed in the rearward facing position.
4. Never use the child seat without fastening the child's harness correctly, and never attempt to use it without fastening it into the car as described in these fitting instructions, if the shoulder height is not ok, please reinstall the seat again.
5. It is most important that the seat belt is correctly routed and the child seat tightened down on the upholstery as firmly as possible to ensure maximum protection. A recommended method is shown in these instructions.
6. Do not add or modify this product in any way.
7. Never use this product if it has been in an accident, or if it has become badly worn. Periodically inspect the harness for wear, paying particular attention to attachment points, stitching and adjusting devices.
8. Do not leave a child in the seat unattended at any time.
9. Ensure that no part of the seat or seat belt is trapped in a door or a folding seat. If your car has a folding rear seat, ensure that it is correctly latched in its upright position.
10. Car interiors can become very hot when left standing in direct sunlight it is therefore recommended that the child seat, when not in use, is covered by a towel etc. This prevents components, particularly those attached to the child seat, becoming hot and burning the child.
11. In the event of an emergency it is important that the child can be released quickly. This means that the buckle is not fully tamperproof and therefore your child should be persuaded never to play with the buckle.
12. Luggage and other heavy objects should be secured in the car. Loose objects are liable to cause injury in the event of an accident.
13. The child seat must not be used without the cover.
14. Never place your child seat on a table or work surface.
15. This seat can be used for children of 0 - 13kg in weight and is used in conjunction with a 3-point lap and diagonal safety belt in the rear-facing position only.
16. When the child seat is not in use, it is recommended that it is fastened into the car with a seat belt to avoid cause injury in the event of an accident.
17. In an emergency your child can be released quickly by pressing the red button on the harness buckle.
18. Store this child seat in a safe place when it is not being used. Avoid placing heavy objects on top of it.
19. If you travel with passengers using both the front and rear passenger seats, the lighter occupants should be in the rear and the heavier occupants in the front of the vehicle.
20. Do not allow your child seat to come into contact with corrosive substances e.g. battery acid.
21. Do not leave the child seat with a child in it on a raised surface, such as a table work top, bed or shopping trolley, due to the risk of falling.
22. The manufacturer can only guarantee the safety of the seat if it is used by the original owner.
23. We strongly advise against using a second-hand product, as you can never be sure of its history.
24. Always check to make sure the seat fits in your car properly before purchasing it.

# Parts List

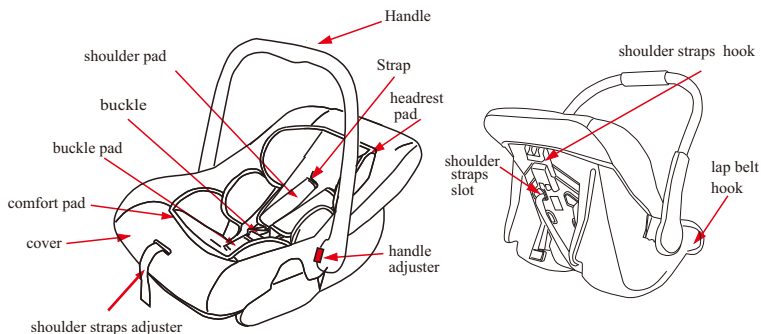

## The correct fitting position in the car



**Correct**



**Incorrect**

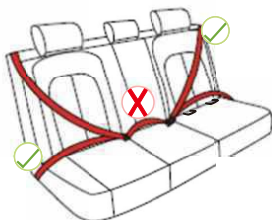

This car seat is not suitable for a car that has only a lap belt.

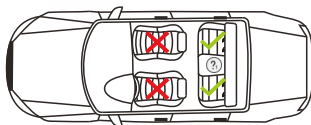

## Check whether the height of harness straps is correct



Too low



Too high



Correct

Always check that the shoulder straps are at the correct height for your child. The child's shoulder should always be below the slot for the harness straps.

## Adjustment of harness straps

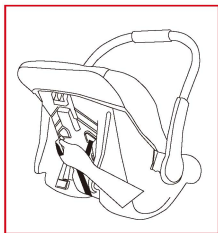

Step 1: Loosen the shoulder straps, open the buckle.

Step 2: Pull out the buckle tongues from the chest pad and the slots on the cover and the shell, then thread them into the corresponding belt slots. Ensure that both of the shoulder belts go through slots at the same height, and are not twisted.

## Tighten the shoulder restraint



Step 1. The shoulder straps are slackened by pressing the lever (under the seat cover) on the front of the seat.

Step 2. Press down the adjuster as you grip the two shoulder straps with your other hand and pull the shoulder straps towards you to loosen it.

## Securing the baby with the harness

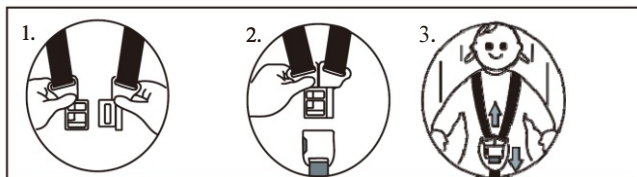

First step

Second step

Third step

Step 1. Loosen the harness, open the buckle and place them down side ways. Seat your child in the child car seat. Place both shoulder straps over your child's shoulders. Fig 1.

NOTE: Baby below 5kg, using comfort pad and headrest pad  
Baby above 5 kg, only using headrest pad.

Step 2. Put the two sections of the buckle connectors together. Fig 2.

Slot the two buckle connectors into the slot in the top of the buckle until they "click" into place. Check the harness is correctly locked by pulling the shoulder

straps upwards. Fig 3.

## Adjust the harness straps

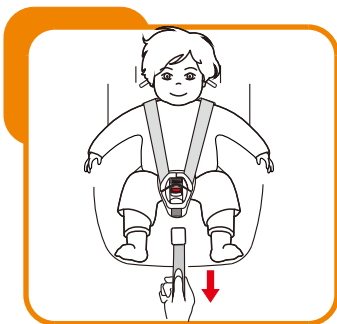

### Tighten the shoulder restraint

Adjust the harness straps.

To tighten the shoulder straps.

Pull the adjustment strap until tight but not too tight or uncomfortable for the child.

## Fitting the child restraint

Please read the operating handbook in your vehicle to inform yourself about the basics concerning children's seats in vehicles.

Do not place this baby seat on seats with front airbags.

This baby car seat can only be installed using a three-point vehicle belt.

The baby car seat must be installed rearward facing. Fig 1.

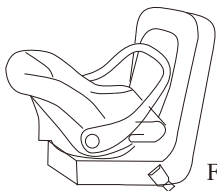

Fig.1

### Step 1.

Adjust the handle to the forward position. Handle must be firmly against the backrest of car's seat.

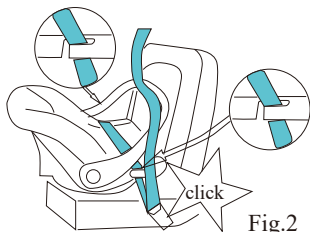

Fig.2

### Step 2.

Slide the lap belt of the vehicle's 3-point seat belt through both lap belt guides and fasten the car seat buckle. Fig 2. Pull the shoulder strap tight to take up any slackness.

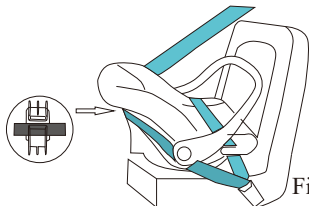

Fig.3

### Step 3.

Pull the shoulder strap belt diagonally around the back of the child car seat and slide it through the guide hook. Fig 3.



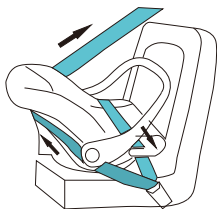

Fig.4

#### Step 4.

Tighten the vehicle's own 3-point seat belt by pulling hard on the positions shown. Fig 4.

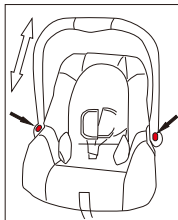

Fig.5

Step 5. Ensure all straps and buckles are located and adjusted correctly. Fig 5. You can contact the child car seat manufacturer if in doubt about this point.

Make sure all the belts position is right and they have not become twisted. Also check that the cover is not impeding the movement or fit of the belt webbing in any way.

To release your baby car seat following the above instructions in reverse order.



### Handle adjustment

The handle for the baby car seat can be snapped into 4 positions. To adjust the handle, press the red buttons of the handle on both sides at the same time and adjust to required position.

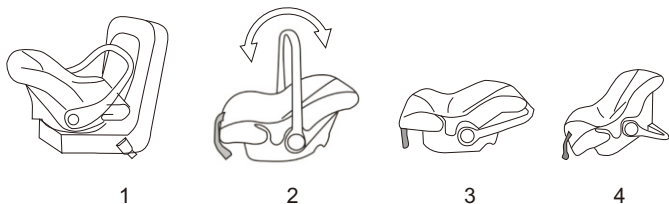

Position one. Rearward facing installed in the car. This position (only this position) is suitable for the baby car seat installed on the vehicle seat.

Position two. Straight up for carrying.

Position three. Handle clicked back to initiate the rocking feature.

Position four. Down to support baby for feeding and play.

Ensure that the handle is locked in a position, the harness is correctly fitted and the buckle fastened before carrying your car seat.

### **The fitting of the canopy**

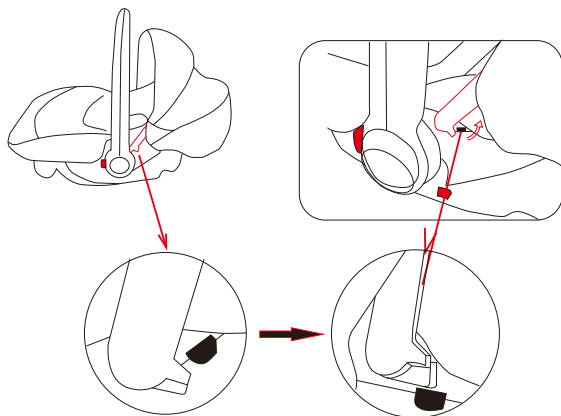

Push both ends of the canopy clips on to the frame, just behind the handle.

## **General Care:**

Cover cleaning instructions

- Hand wash at max 30 - do not wring.
- Do not iron.
- Do not bleach with chlorine.
- Do not dry clean, do not use solvent based stain removers.
- Do not tumble dry.
- The hood may be spot cleaned in situ with a mild detergent solution and allowed to air dry.

## **Maintenance**

- This product requires a small amount of maintenance. Cleaning and maintenance must only be carried out by adults.
- Keep all moving parts clean and if necessary lubricate them with a silicone based spray.
- Clean the plastic parts periodically with a damp cloth. Do not use solvents or similar substances.
- Brush the fabric parts to remove dust.
- Do not clean the polystyrene shock absorbing device with solvents or other similar products.
- Protect the product from atmospheric agents: humidity, rain or snow. Extended exposure to sunshine can cause colour changes in many materials.
- Store the product in a dry environment.

## **Cleaning the seat:**

- The harness and plastic parts can be sponged with very mild detergent and warm water.
- Do not use chemical cleanser, bleach, corrosives on any part of the seat.

For all technical queries please call:  
01454 326 568

Imported by:  
The Red Lite Baby Co Ltd  
35 Lavenham Road  
Beeches Industrial Estate  
Yate  
Bristol  
BS37 5Q

